

F RELAY LOCATIONS

[Engine Compartment]

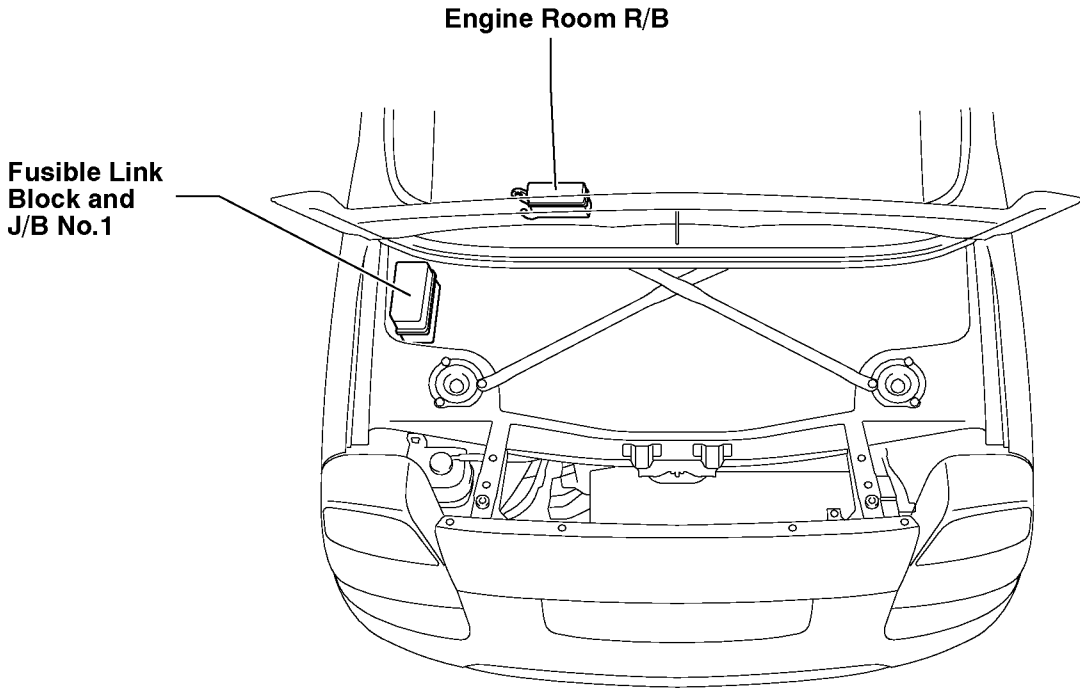

[Instrument Panel]

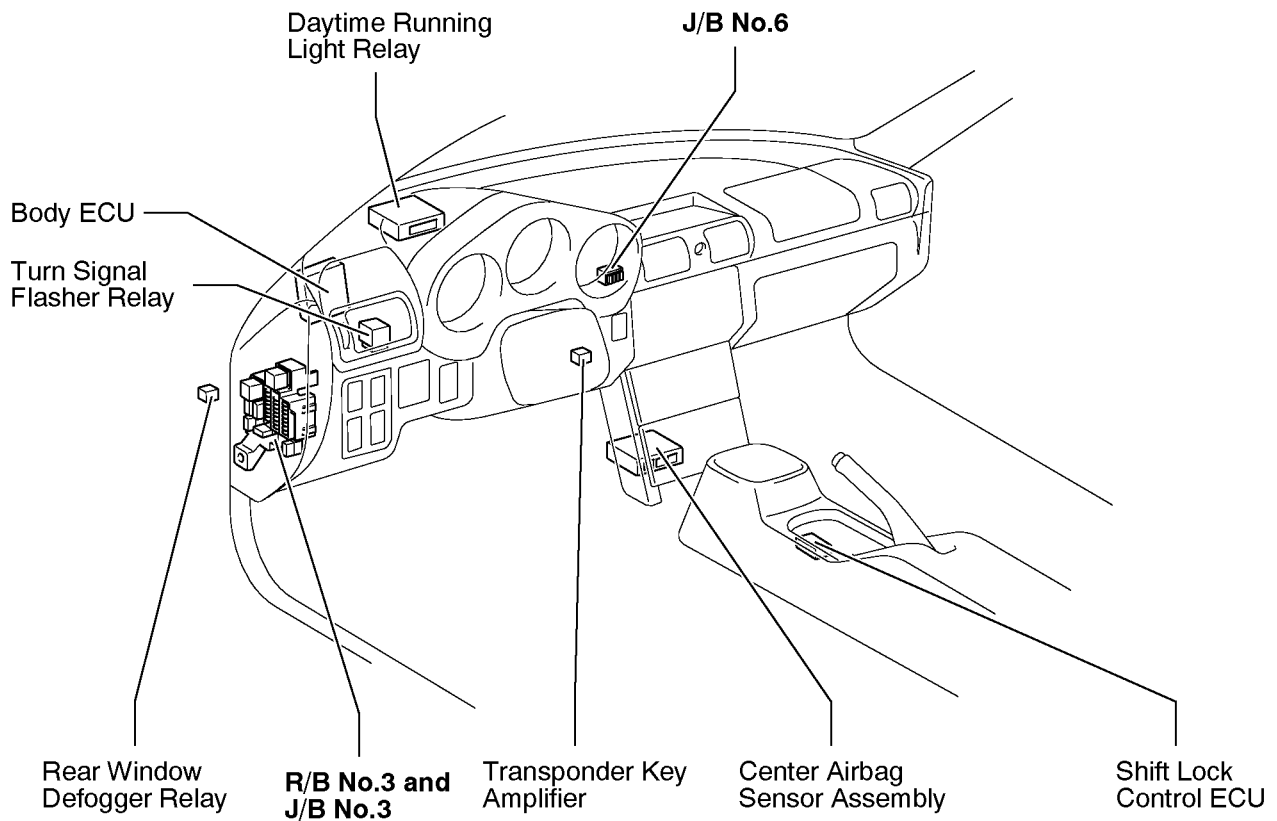

[Body]

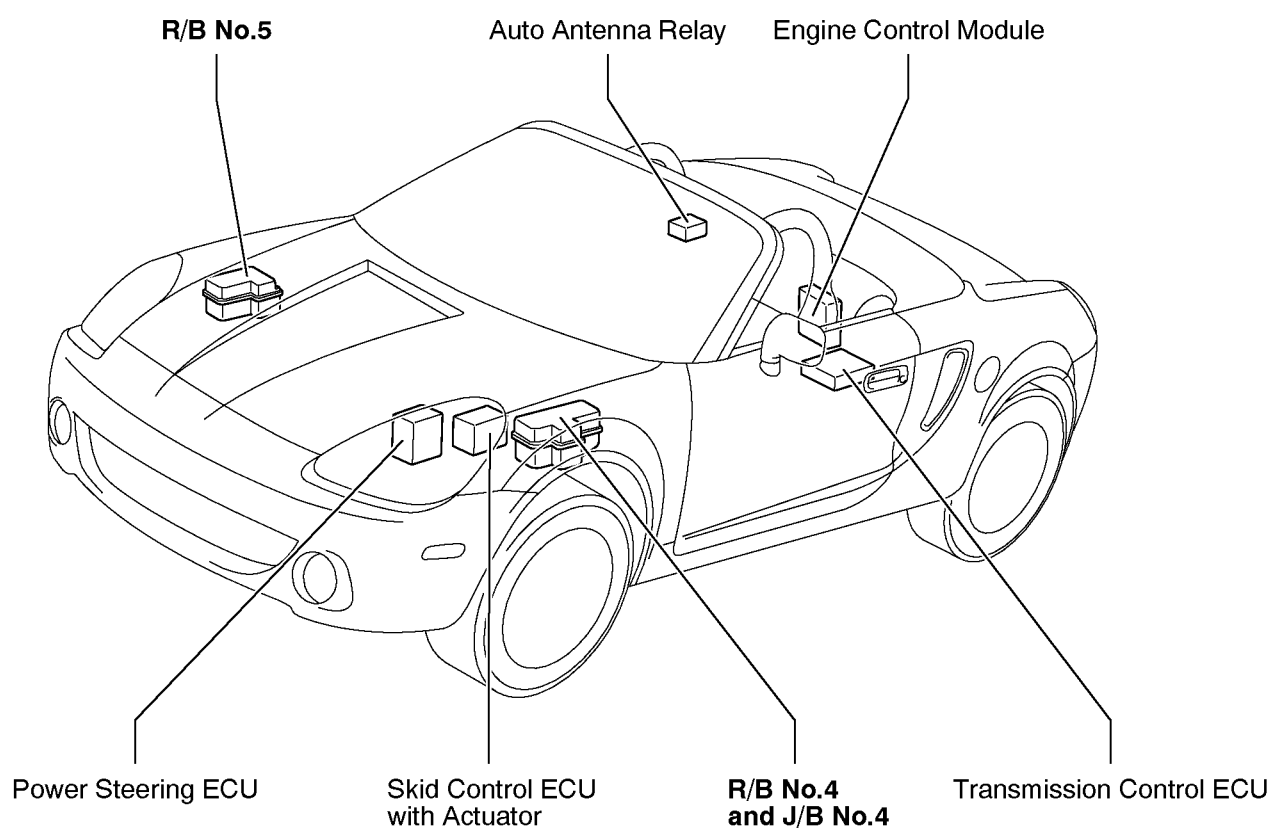

F RELAY LOCATIONS

① : Fusible Link Block	Engine Compartment Left (See Page 20)
○ : J/B No.1	

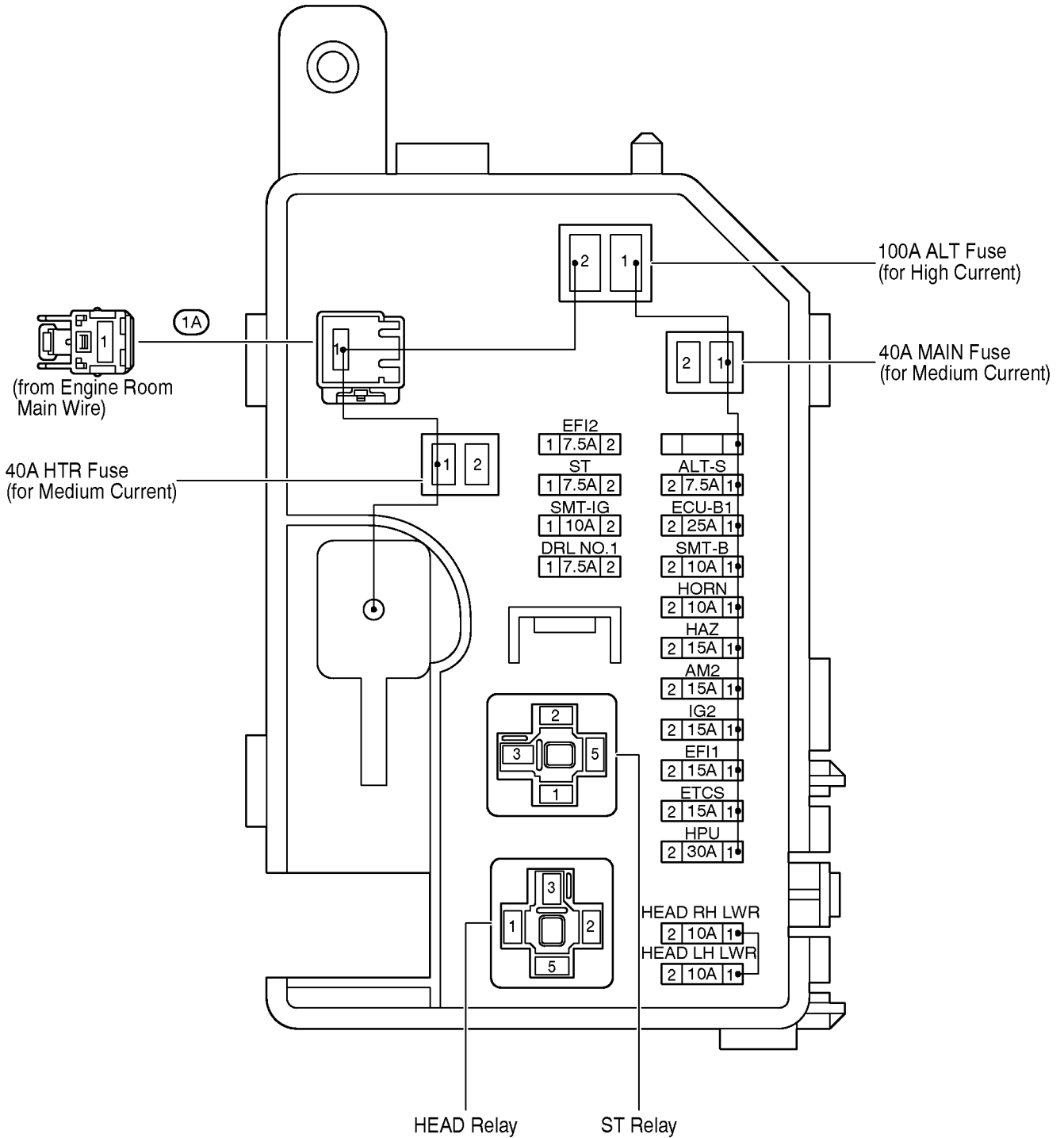

② : Engine Room R/B Left Side of Room Partition Panel
(See Page 20)

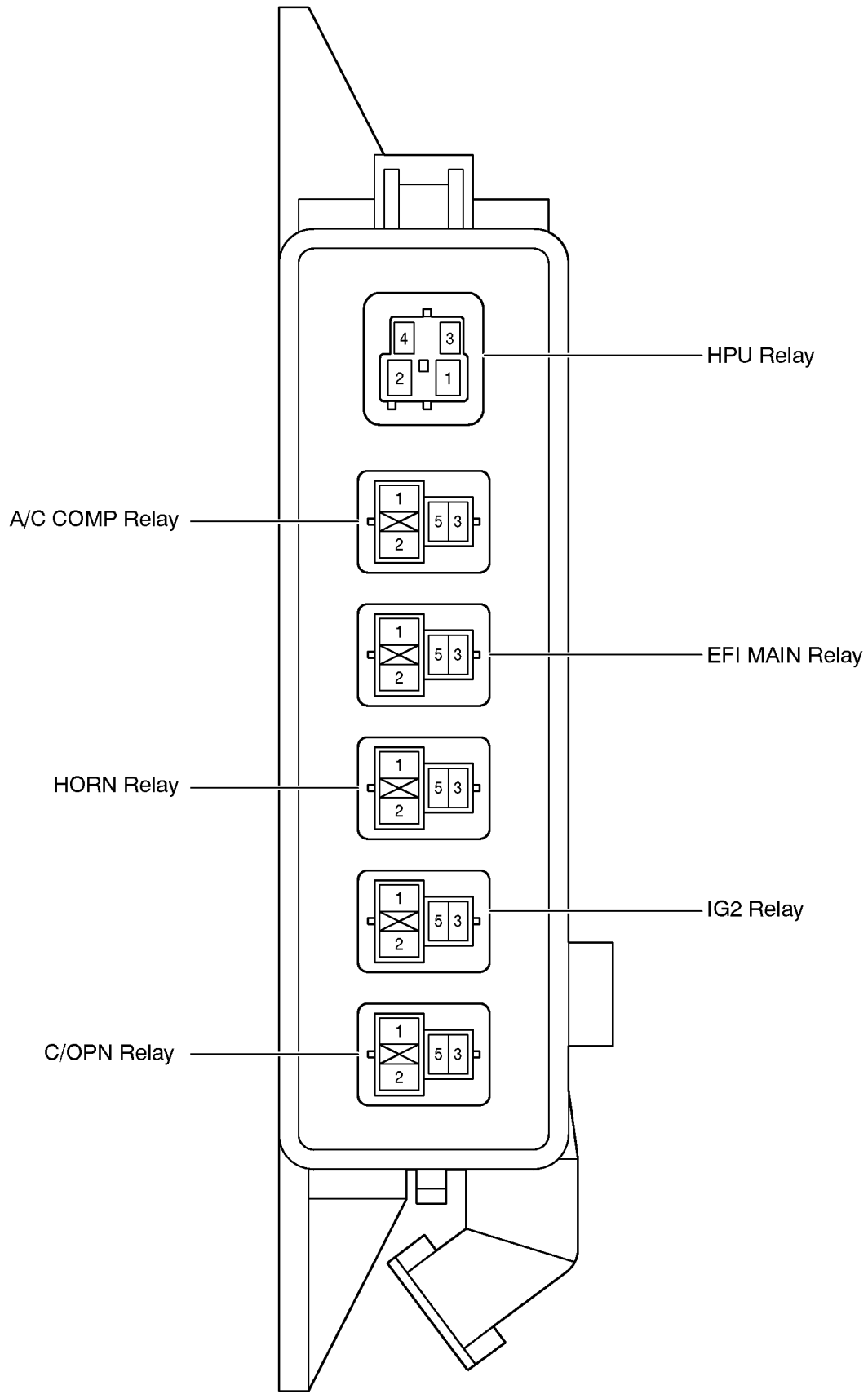

F RELAY LOCATIONS

③ : R/B No.3	Left Side of Instrument Panel (See Page 20)
○ : J/B No.3	

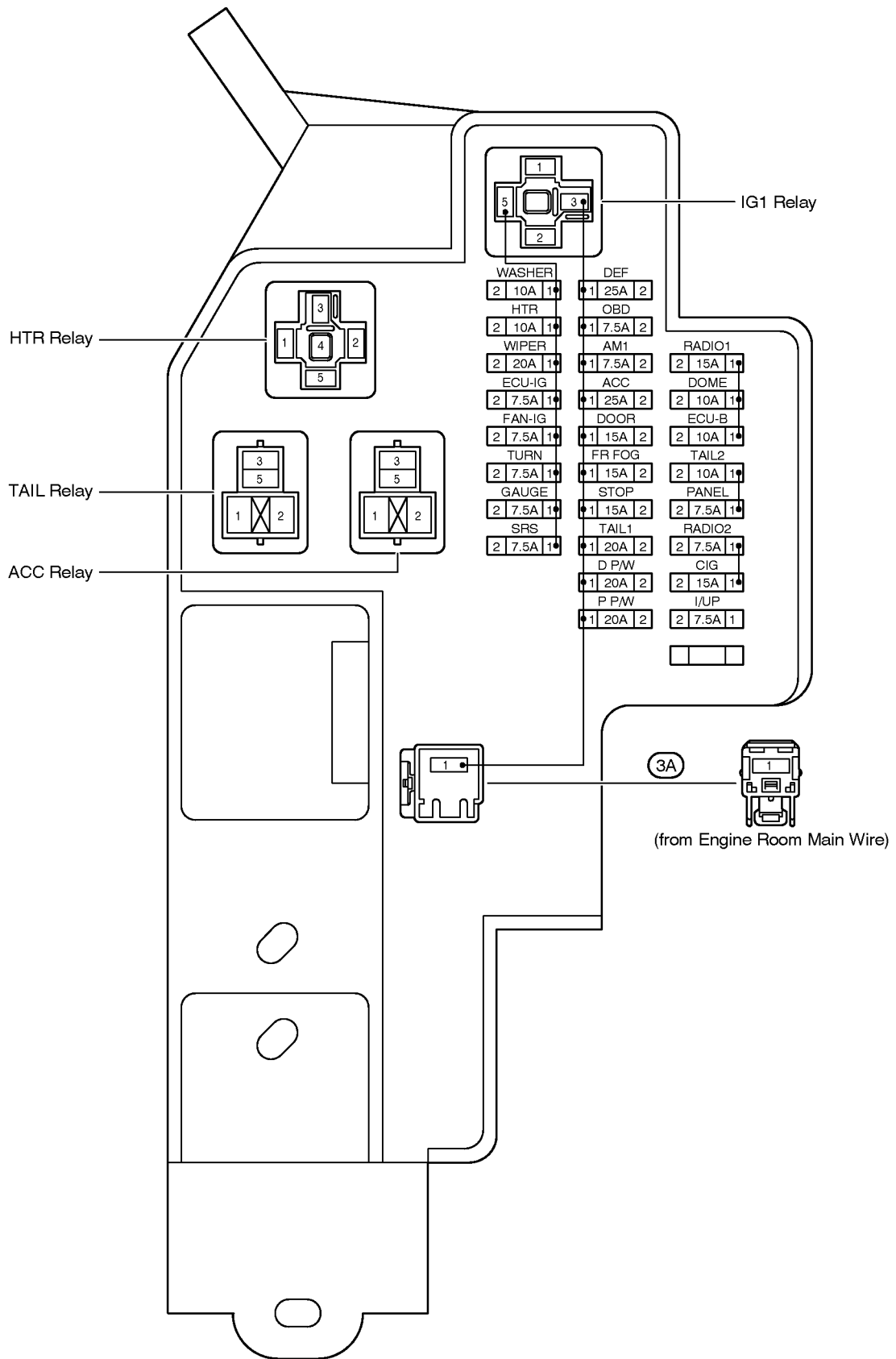

<p>④ : R/B No.4</p> <p>○ : J/B No.4</p>	<p>Front Compartment Left (See Page 21)</p>
---	--

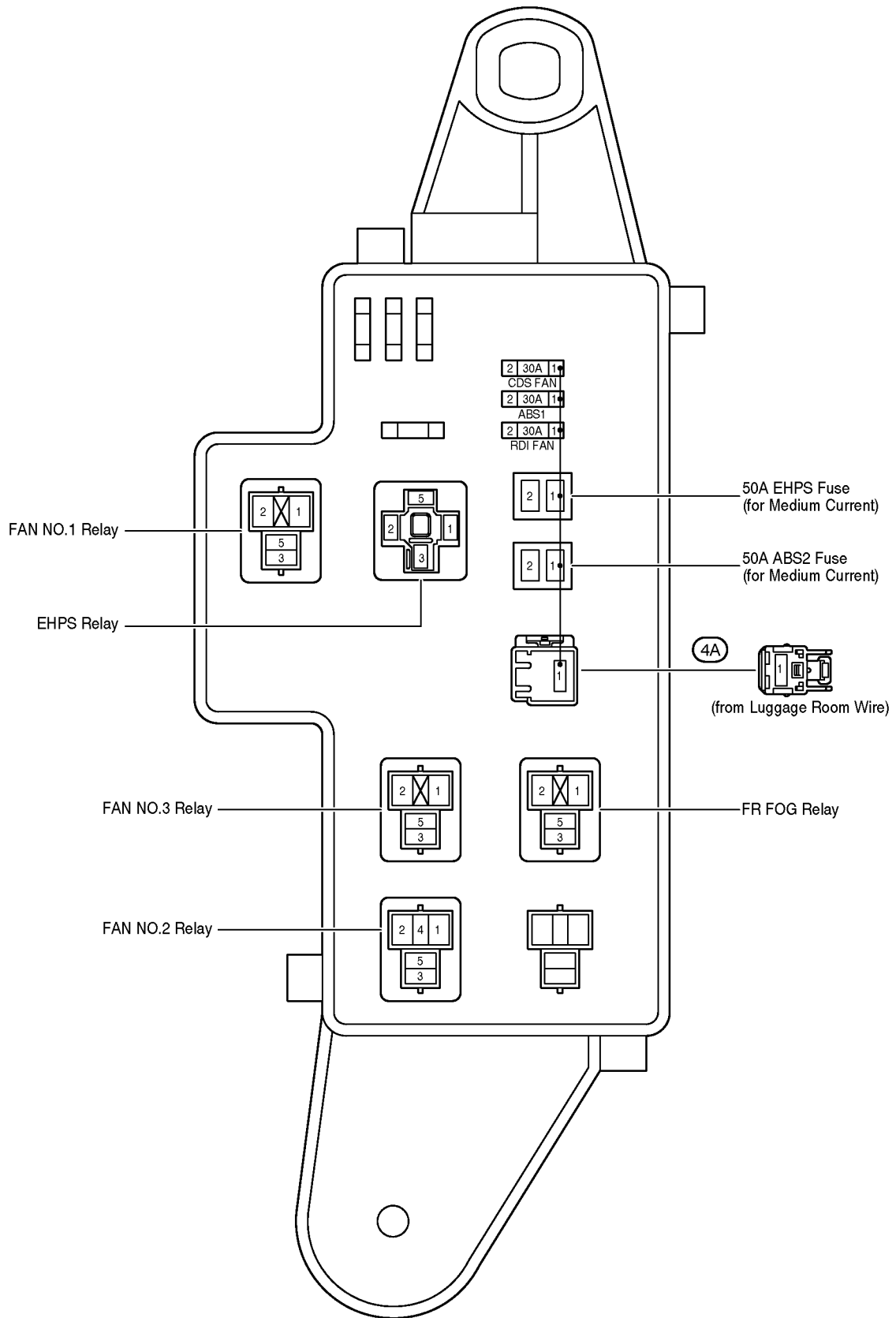

F RELAY LOCATIONS

○ : J/B No.6 Instrument Panel Brace LH (See Page 20)

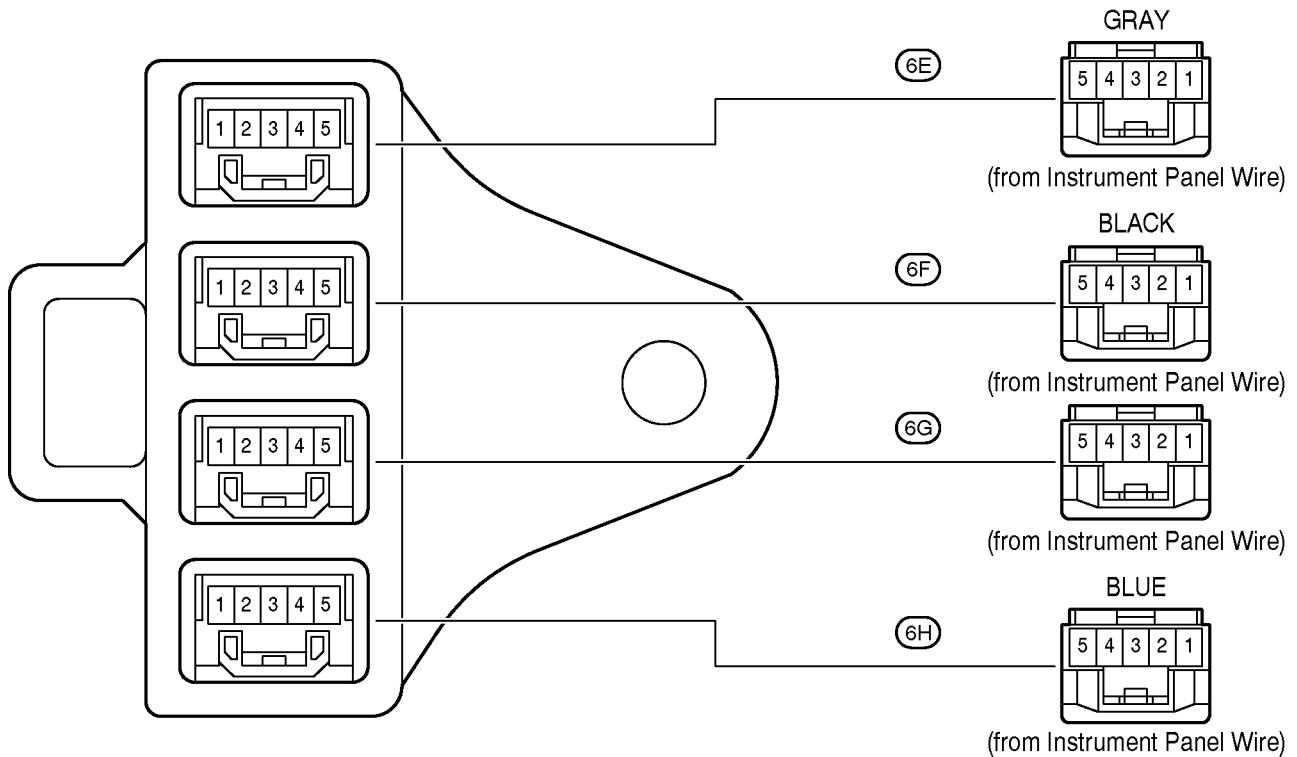
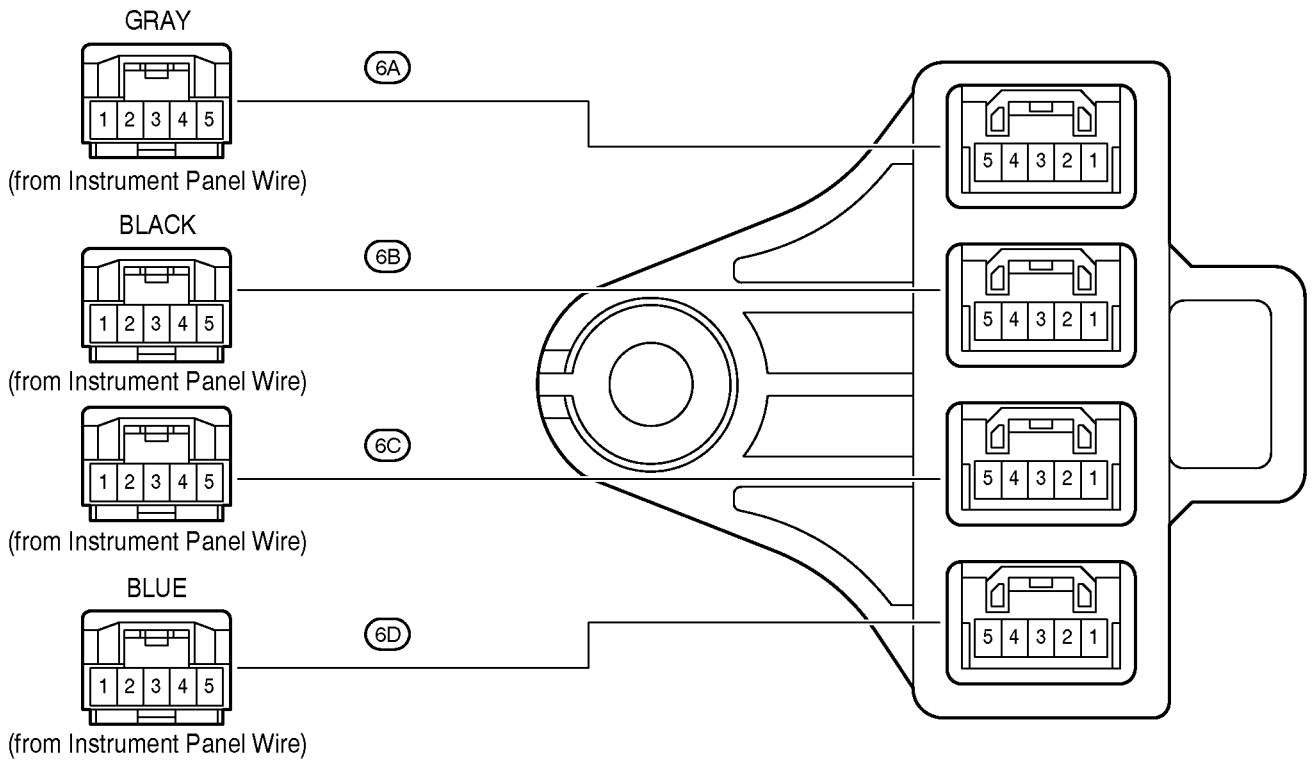

[J/B No.6 Inner Circuit]

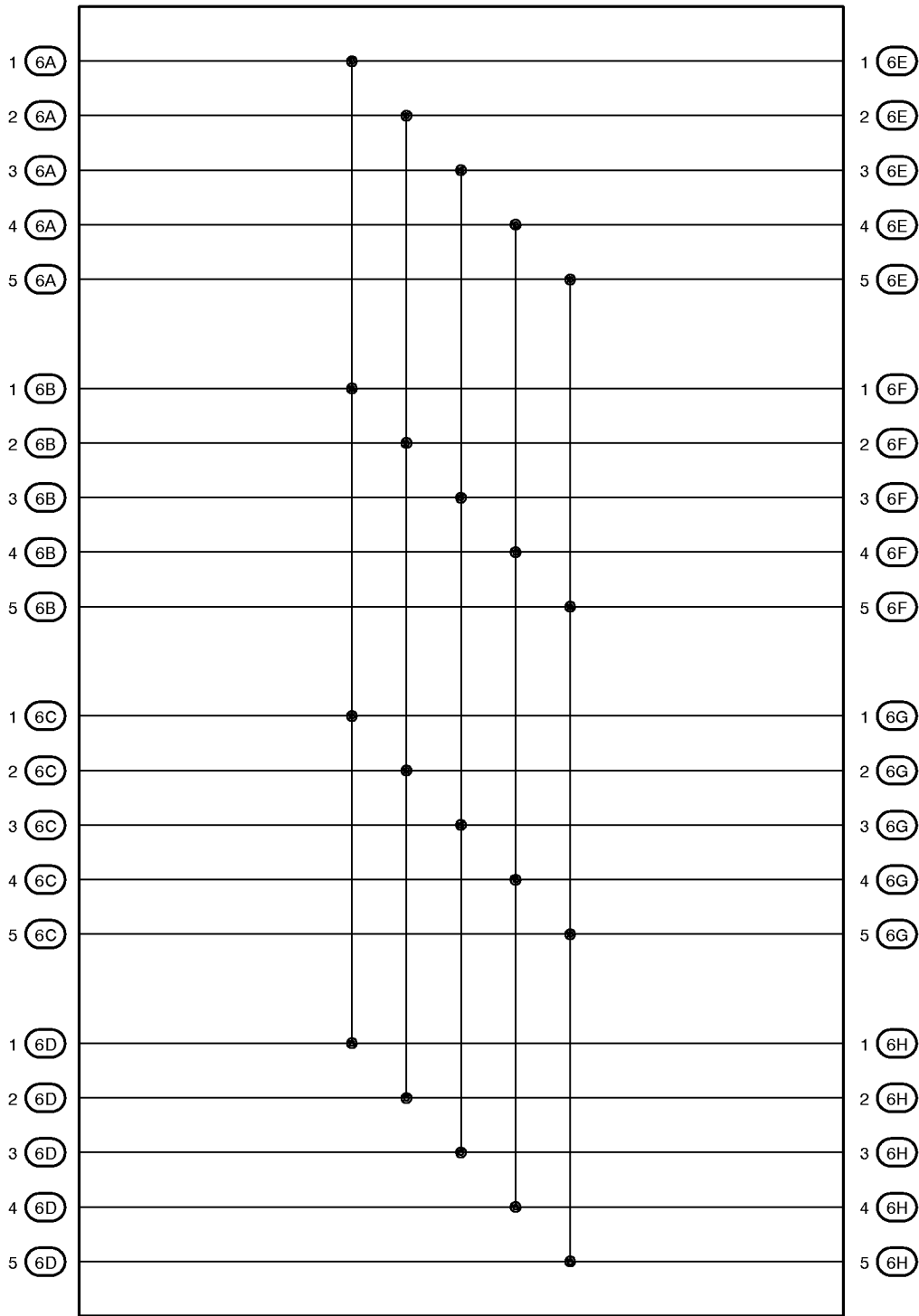

F RELAY LOCATIONS

⑤ : R/B No.5 Front Compartment Right (See Page 21)

